

## Models

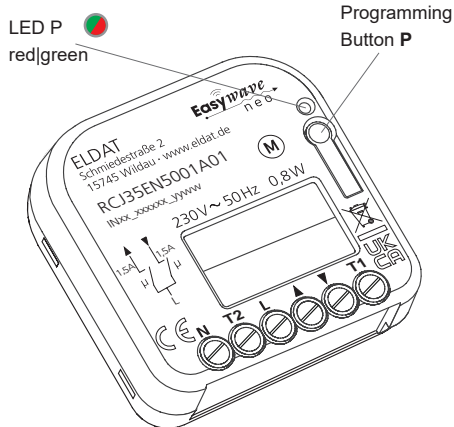

RCJ35EN5001A01

## Wiring diagram

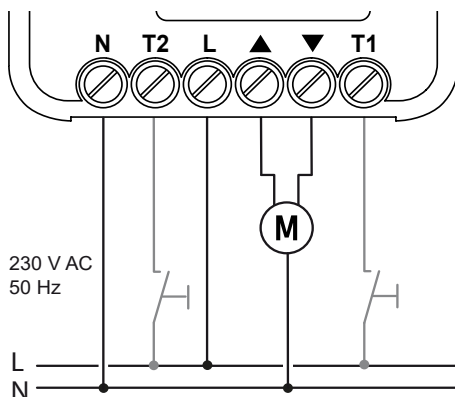

## Wire cross-sections

Only wires with a cable cross-section of 0.5 mm<sup>2</sup> to 2.5 mm<sup>2</sup> shall be connected. The stripping length of the connecting wires is 6 to 7 mm.

## Technical Details

Frequency:	868.30 MHz
Radiated power:	6.38 mW
Modulation:	FSK
Coding:	Easywave neo POTA
Device type:	motor control
Power supply:	230 VAC, 50 Hz
Input:	2 external buttons
Output:	2 potential-loaded relay contacts (normally open)
Power consumption:	0.4 W standby 0.8 W max. w/o load
Maximum contact load	
- resistive load $\cos\phi = 1.0$	5 A / 1,150 VA
- inductive load $\cos\phi = 0.8$	1.5 A / 345 VA
Operating temperature:	-20 °C to +45 °C
Dimensions (H/W/D):	43.0/42.0/17.5 mm
Weight:	approx. 31 g

## Scope of Delivery

Flush mounted receiver RCJ35, operating manual

## Intended Use

The device may only be used to control tubular motors and only indoors! It is operated using Easywave radio transmitters or external buttons.

The manufacturer will not be liable for damage caused by improper or inappropriate use.

## Safety Advice



Before installing the device, carefully read through this operating manual! Failing to observe these instructions may result in fire or other hazards.

- The electrical installation may only be performed by an authorised and qualified electrician.
- The load current circuit on which the device is operated must be protected by a circuit breaker switch in accordance with EN60898-1 (tripping characteristic B or C, max. 5 A rated current).
- We will not accept any liability for personal injury or damage to property caused by failure to observe the operating instructions and in particular the safety advice!
- Observe the applicable laws, standards and regulations as well as the manufacturer's instructions for the devices to be operated!
- Have faulty units checked by the manufacturer!
- Do not open the unit housing!
- Do not make any unauthorized alterations or modifications to the unit!



## Function

Using the bidirectional flush-mounted receiver RCJ35, a tubular motor can be controlled via Easywave transmitters or via two button inputs. 32 transmission codes can be programmed into the receiver.

The RCJ35 is equipped with operating modes UP/DOWN, UP/STOP/DOWN and SEQUENCE. The „slat adjustment“ function is also available as an option, whereby the motor is controlled in DEAD MAN mode for the first 2 seconds of transmitter actuation and only then switches to self-retaining.

The runtime of the motor can be set separately for each movement direction. The runtime is 90 seconds each ex-factory.

The integrated POTA (Programming Over The Air) remote programming function can be used to reprogram an already-installed and no longer accessible receiver. A detailed POTA programming manual is available on our website:

[https://www.eldat.de/pota\\_en.pdf](https://www.eldat.de/pota_en.pdf)

or you can request support from our customer service.

## Push-button inputs T1 and T2

The RCJ35 has two push-button inputs (T1 and T2), which have to be connected to L.

In the factory state, the button inputs operate in the UP/DOWN 2-button operation mode without slat adjustment. The external buttons can be programmed in a different operating mode or deleted at any time. This is done in the same way as programming Easywave transmitters.

If an external push-button is deleted, it operates again in the ex-factory operating mode.

Button input T1 behaves like a transmitter button with button code A; button input T2 behaves like button code B.

In 1-button and 2-button operation, the movement command is carried out by briefly pressing the connected buttons.

In 3-button operation, the buttons or switches must remain pressed for the desired period of movement. As long as a button input is active, no transmitter commands are accepted in the 3-button operation.

## Operation

Briefly press button P to begin programming mode for the required operation type. Any Easywave transmitter can then be programmed under this operation type. Each transmitter can be assigned its own operating mode. A separate operation type can be assigned to each transmitter / transmitter button. For local operation, 2 external buttons can be connected.

## 2-button-operation

In this operating mode, movement commands are triggered by 2 related transmitter buttons. The movement is stopped by pressing the button for the opposite direction. Only one transmitter button must be programmed, the code for the associated button is assigned automatically.

## 3-button-operation

In 3-button operation, movement commands and the stop command are each triggered by a separate transmitter button. This operating mode is therefore particularly suitable for central control and the use of repeaters.

A transmitter with at least three associated buttons is required. Only one of these transmitter buttons must be programmed into the receiver, the code for the corresponding buttons is assigned automatically.

## 1-button-operation

Using a single transmitter button, move and stop commands are triggered in a defined sequence each time it is pressed.

A transmitter with four buttons (A, B, C, D) could therefore be used to control, e.g. four different devices.

Timeout<sup>(1)</sup>

If no button is pressed within 30 seconds, the RCJ35 automatically switches to operation mode. The settings are not saved.

## Operating modes

## 2-button-operation

## UP/DOWN

Transmission code A or C	Roller shutter UP
Transmission code B or D	Roller shutter DOWN

STOP with opposite direction button optionally with slat adjustment

## 3-button-operation

## UP/STOP/DOWN

Transmission code A	Roller shutter UP
Transmission code C or D	Roller shutter STOPS
Transmission code B	Roller shutter DOWN

optionally with slat adjustment

## 1-button-operation

## SEQUENCE

Transmission code A/B/C/D

The roller shutter executes movement commands one after another:

UP → STOP → DOWN → STOP → UP → ...

## SETTING UP THE RECEIVER

**⚠ The receiver must be installed and commissioned by a qualified electrician in a commercially available flush-mounted installation box.**

- Switch off the power supply.
- Connect the supply voltage and the tubular motor to be controlled according to the wiring diagram. Observe the applicable electrical regulations!
- Switch on the power supply again and transfer the coding of the transmitter buttons to the receiver.
- Seal the flush-mounted installation box with the corresponding cover.

**⚠ The cable length for connecting external buttons must not exceed 3 meters.**

**👉 Make sure there is no interference with the wireless connection!** Do not mount the device in a distribution box, in metal casings or in direct proximity to large metal objects.

## PROGRAMMING

### Program transmitters

The RCJ35 only responds to programmed Easywave transmitters. To program a transmitter, set the RCJ35 to the programming mode for the desired operating mode and then press the transmitter button to be programmed or, if necessary, a button connected to the T1/T2 button input. Up to 32 transmission codes can be programmed. If an already programmed transmitter is programmed again, the previous operation mode is overwritten by the new selection. A button input occupies a memory location as soon as it is programmed into another than the default an operating mode.

Operation <sup>(1)</sup> [Press button]	Indication	Note
<b>UP/DOWN 2-TB</b>		
① <b>P</b> 1x briefly	LED P flashes red	Operating mode <b>UP/DOWN</b> selected
② <b>Tx</b> Transmitter button 1x briefly	LED P lights up 2 seconds red	Transmission code is programmed. When the LED turns off, the receiver is ready for operation.
<b>UP/DOWN 2-TB with slat adjustment</b>		
① <b>P</b> 1x briefly <b>P</b> 1x long	LED P flashes red LED P flashes green	Operating mode <b>UP/DOWN</b> Operating mode <b>UP/DOWN + slat adjustment</b> selected
② <b>Tx</b> Transmitter button 1x briefly	LED P lights up 2 seconds green	Transmission code is programmed. When the LED turns off, the receiver is ready for operation.
<b>UP/STOP/DOWN 3-TB</b>		
① <b>P</b> 2x briefly	LED P flashes red	Operating mode <b>UP/STOP/DOWN</b> selected
② <b>Tx</b> Transmitter button 1x briefly	LED P lights up 2 seconds red	Transmission code is programmed. When the LED turns off, the receiver is ready for operation.
<b>UP/STOP/DOWN 3-TB with slat adjustment</b>		
① <b>P</b> 2x briefly <b>P</b> 1x long	LED P flashes red LED P flashes green	Operating mode <b>UP/STOP/DOWN</b> Operating mode <b>UP/STOP/DOWN + slat adjustment</b> selected
② <b>Tx</b> Transmitter button 1x briefly	LED P lights up 2 seconds green	Transmission code is programmed. When the LED turns off, the receiver is ready for operation.
<b>SEQUENCE 1-TB</b>		
① <b>P</b> 3x briefly	LED P flashes red	Operating mode <b>SEQUENCE</b> selected
② <b>Tx</b> Transmitter button 1x briefly	LED P lights up 2 seconds red	Transmission code is programmed. When the LED turns off, the receiver is ready for operation.
<b>RUNTIME MEASUREMENT</b>		
① <b>P</b> 3x briefly <b>P</b> 1x long	LED P flashes red LED P flashes alternately red green	Operating mode <b>SEQUENCE</b> selected start <b>RUNTIME MEASUREMENT</b> (see page 3)

### Programmierstruktur

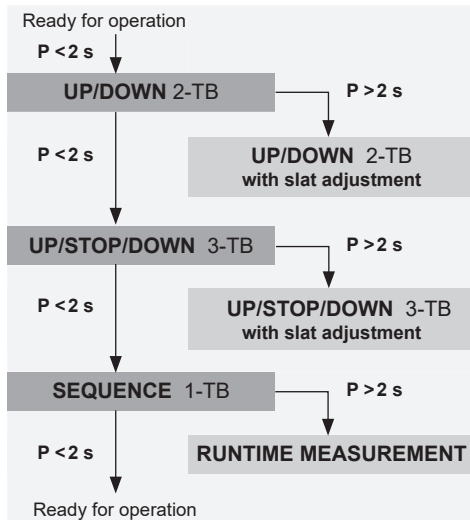

① **P** Select operating mode

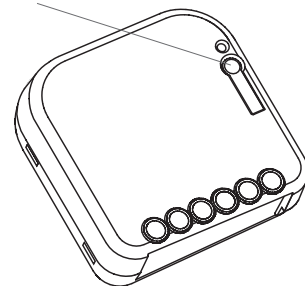

② **Tx** Send transmission code

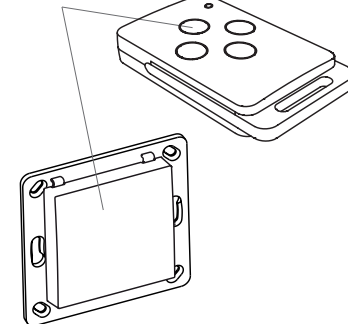

**👉** A programming process can be cancelled by briefly pressing the **P** programming button several times. Once the LED turns off, the receiver returned to standby.

## EXPLANATION

### LED indications

- off
- lights
- flashes
- flashes quickly

### Press button

- briefly** (<2s) = Press button for less than 2 seconds
- long** (>2s) = Press button longer than 2 seconds

### Operation

- 1-TB** = 1-button operation
- 2-TB** = 2-button operation
- 3-TB** = 3-button-operation

## PROGRAMMING

### Measuring the runtime

The runtime of the RCJ35 outputs can be set individually for both directions. This protects the end position switches of a connected motor and enables the targeted approach of positions when controlled by a server (e.g. APC01).



Each movement command received is carried out for the currently set runtime. This runtime applies to all programmed transmitters, even if the transmitters were already programmed before a measurement. The maximum runtime that can be set is approx. 1.8 hours.

To be able to carry out a runtime measurement, at least one transmitter must be programmed into the RCJ35. Start the runtime measurement with the roller shutter completely open. Then, using a programmed transmitter, move the roller shutter to both end positions and give a STOP command as soon as the roller shutter has reached an end position (regardless of whether the roller shutter has already stopped independently). The more precisely you send the STOP command when the end positions are reached, the more precisely positions can be approached later with a server (e.g. APC01).

You can repeat the measuring runs as often as you like as long as the runtime measurement is active. The last measured runtime for each direction is saved. If the runtime measurement was started with a transmitter, it must be completed with exactly the same transmitter. Other transmitters are ignored for the duration of the measurement.

The factory setting (restored after a reset) for the runtime is 90 seconds for both directions.

#### Operation <sup>(1)</sup>

[Press button]	Indication	Note
① P 3x briefly P 1x long	LED flashes red LED P flashes alternately red green 	start <b>RUNTIME MEASUREMENT</b>
② move to both end positions	LED P flashes alternately red green	Move the roller shutter to both end positions using a programmed transmitter. Send a STOP command in <b>both</b> end positions! For each direction of travel, the last movement time between two STOP commands is measured.
③ P 1x long	LED P lights up 2 seconds green 	End the runtime measurement and save the values. When the LED turns off, the receiver is ready for operation.

 If an attempt is made to start the runtime measurement without at least one transmitter being programmed, the LED P flickers red for 4 seconds and the receiver switches back to operating mode.

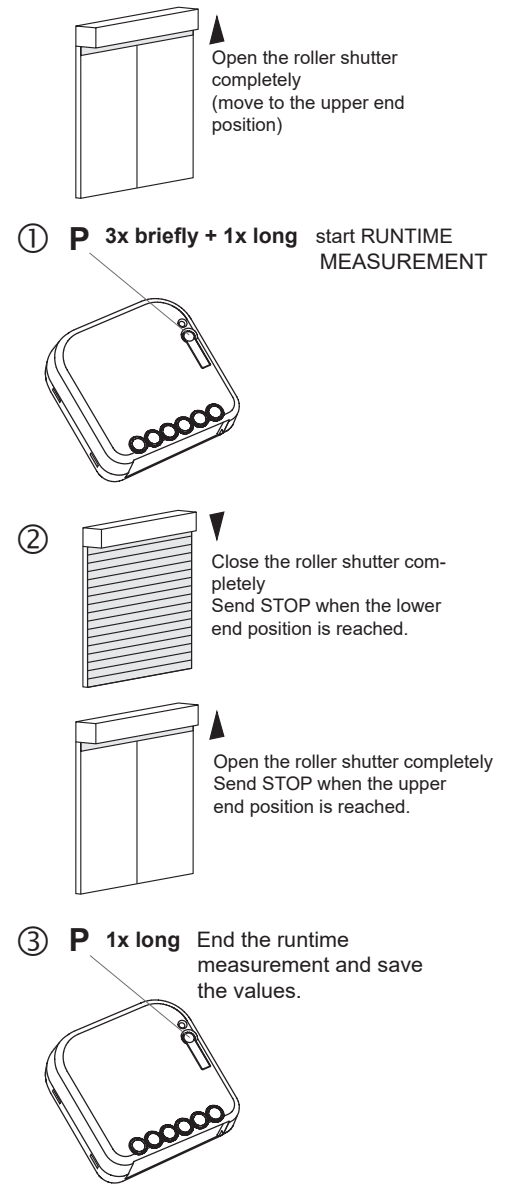

The runtime measurement can be cancelled by briefly pressing the programming button P. This discards all currently measured values.



### Deleting transmitters

In delete mode, individual transmitters can be specifically deleted from the memory of the RCJ35.

#### Operation <sup>(1)</sup>

[Press button]	Indication	Note
① P 1x long	LED P flashes quickly red 	Receiver in delete mode.
② Tx 1x briefly	LED P lights up 2 seconds red 	Transmitter has been deleted.

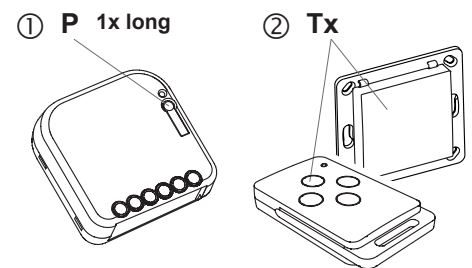

### Reset

Doing a RESET, the receiver will be set back to the factory settings. All programmed transmitters are deleted and the runtime for both directions is set to 90 seconds again.

#### Operation <sup>(1)</sup>

[Press button]	Indication	Note
① P 1x long	LED P flashes quickly red 	Receiver in delete mode.
② P 1x long	LED P lights up 4 seconds red 	All transmission codes have been deleted and the factory settings have been restored.

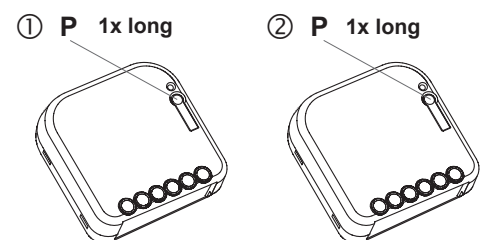

## BI-DIRECTIONAL FUNCTIONS (Easywave neo)

In order to be able to use bidirectional functionalities, a server (e.g. APC01) can be programmed into the RCJ35. The available functions are automatically detected, so no specific operation type needs to be selected when programming a server. Program the server into the receiver according to the instructions in the respective server application by adding an ELDAT actuator as an „Easywave neo“ device. After it is programmed, the server receives feedback about each switching operation performed, even if this is triggered by another transmitter or manually via the external buttons on the RCJ35. The current state of the receiver is therefore always displayed in the associated application.

If the server is to be used to move to specific positions of a roller shutter, a runtime measurement must be carried out in advance.

### Program server

Add an actuator in the Easywave app as an Easywave neo device and follow the instructions in the app. Only one server can be programmed into the receiver. Any server that may have already been programmed will be overwritten.

Operation <sup>(1)</sup> [Press button]	Indication	Note
① Start the programming process via the server application.		
② <b>P</b> 1x briefly	LED P flashes red 	Receiver in programming mode any operating mode possible
③ Complete the programming process via the application.		



Once a server is programmed to the RCJ35, an acknowledgement for each switching operation is transmitted via radio. If the server is not in use, delete it from the receiver to prevent unnecessary radio transmissions.

### Delete the server

A server can be removed from the RCJ35 by deleting the relevant device in the server application. To delete the server, the receiver must be powered and within range of the server. As an alternative to deleting it via the app, the server can also be deleted by resetting the receiver.

- ① Delete the receiver or relevant Easywave neo actuator in the server application, while the receiver is powered and within range of the server.

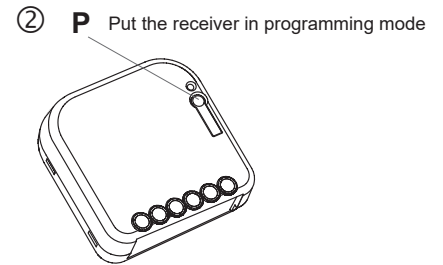
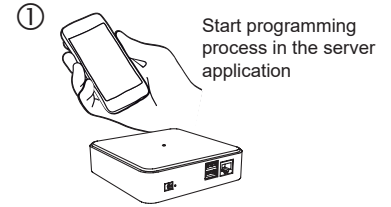

## GENERAL INFORMATION

### Disposal

**Waste electrical products should not be disposed of with household waste!**

Dispose of the waste product via a collection point for electronic scrap or via your specialist dealer.

Put the packaging material into the recycling bins for cardboard, paper and plastics.



### Warranty

We will remedy defects on the device based on material or production errors or exchange the device within the statutory warranty period.

Any unauthorized tampering with, or modifications to, the product shall render this warranty null and void.

### Conformity

Hereby, ELDAT EaS GmbH declares that the radio equipment type RCJ35 is in compliance with Directive 2014/53/EU. The full text of the EU declaration of conformity is available at the following internet address: [www.eldat.de](http://www.eldat.de)



### Customer Service

If the device does not work properly despite proper handling or in case of damage, please contact the manufacturer or your retailer.

#### ELDAT EaS GmbH

Schmiedestraße 2  
15745 Wildau  
Germany

Phone: + 49 (0) 33 75 / 90 37-310

Fax: + 49 (0) 33 75 / 90 37-90

Internet: [www.eldat.de](http://www.eldat.de)

E-mail: [info@eldat.de](mailto:info@eldat.de)